

TITLE

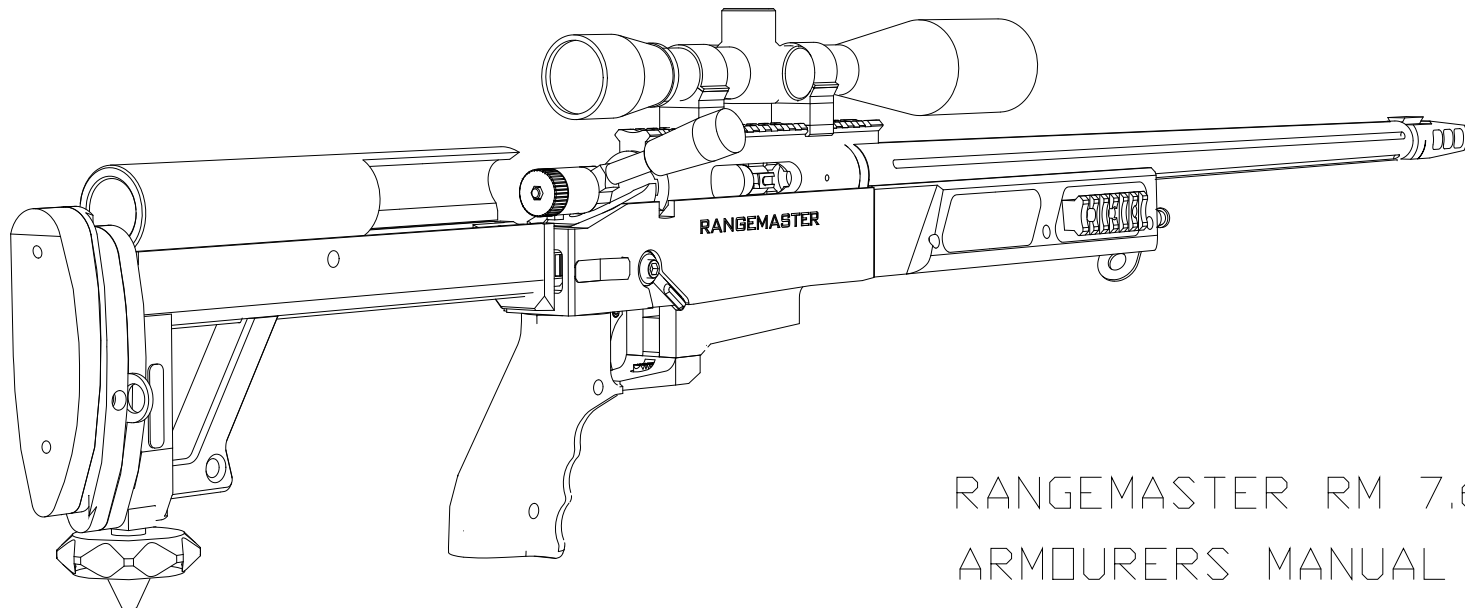

RANGEMASTER RM 7.62 RIFLES
ARMOURERS MANUAL

SPARE PARTS

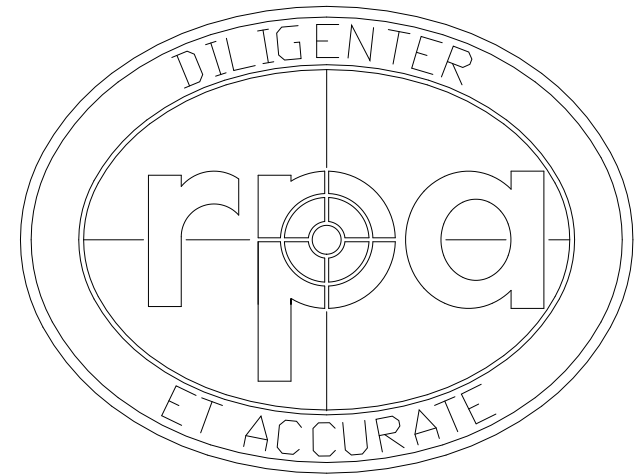
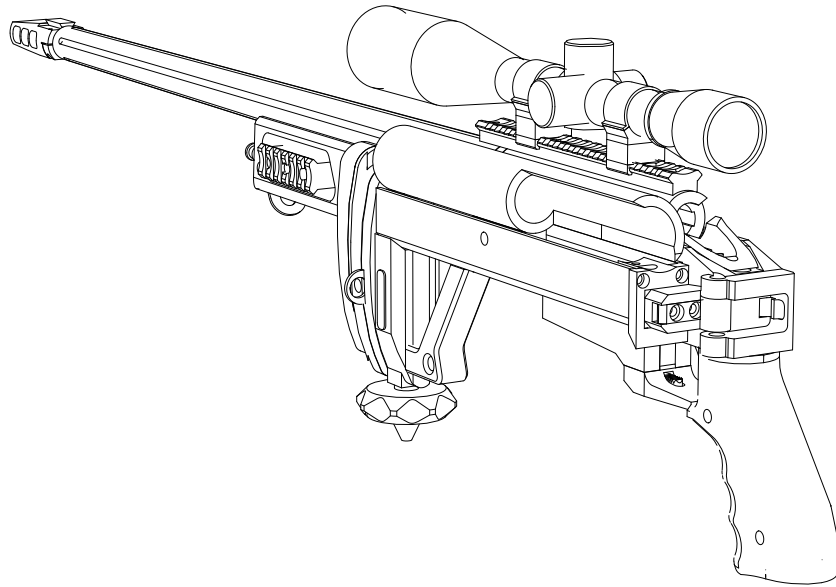

ORDERING PARTS

PLEASE CONTACT YOUR LOCAL RPA DEALER OR CALL RPA INTERNATIONAL
QUOTING THE SERIAL NUMBER OF YOUR FIREARM TO RECIEVE A PARTS
LIST AND IDENTIFY PARTS TO ORDER

SEND OR FAX INFORMATION TO YOUR LCAL RPA DEALER OR;

RPA INTERNATIONAL LTD
PO BOX 441
TONBRIDGE
KENT
ENGLAND
TN9 9DZ

TEL +44 845 880 3222
FAX +44 845 880 3232
EMAIL INFO@RPAINTERNATIONAL.CO.UK
WWW.RPAINTERNATIONAL.CO.UK

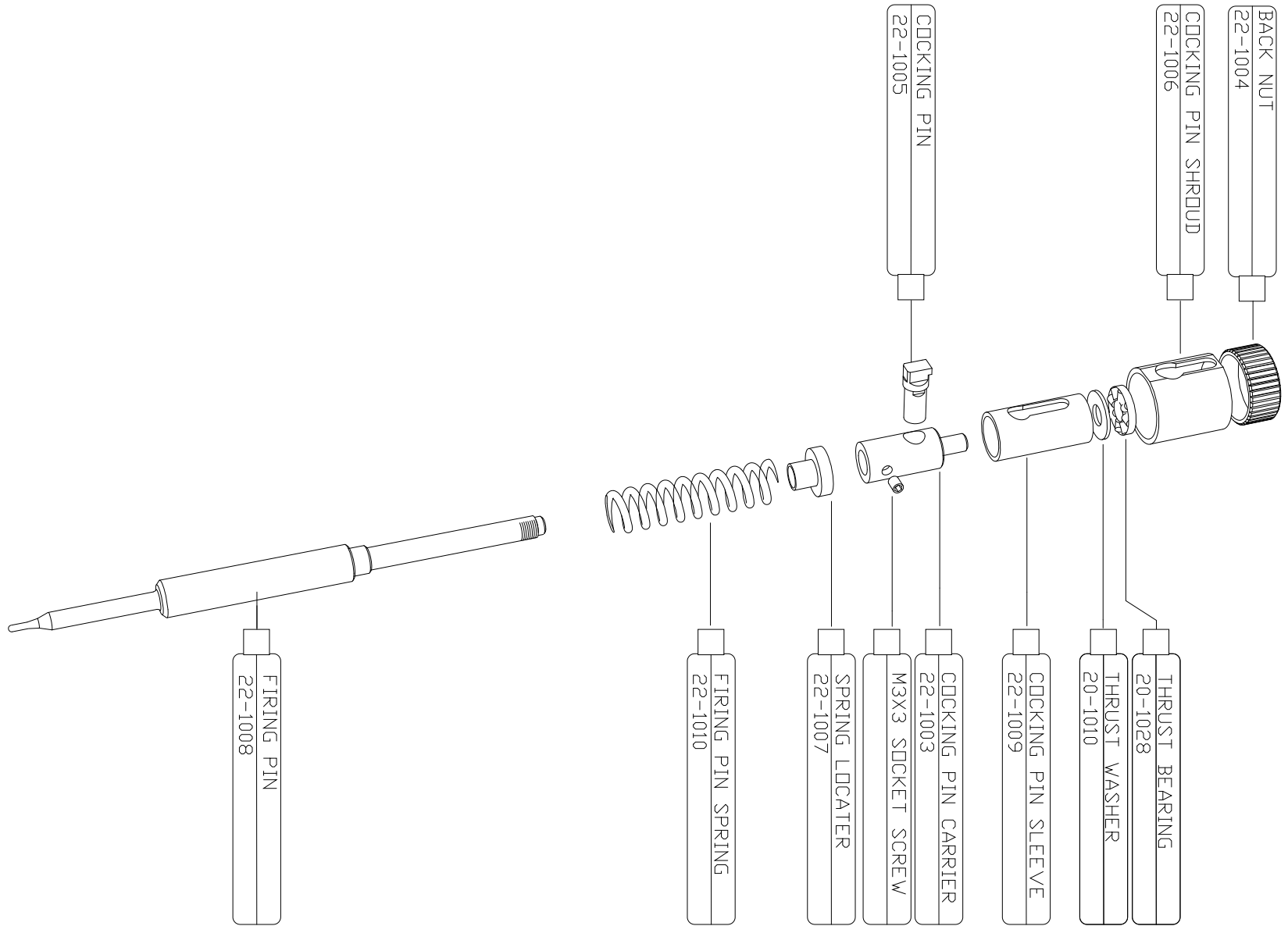
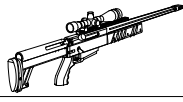
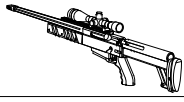

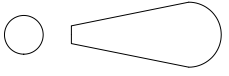
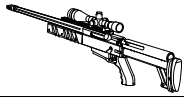

ASSEMBLE THE PARTS TOGETHER
DO NOT FIX COCKING PIN CARRIER INTO PLACE WITH SET SCREW UNTIL
IT HAS BEEN ADJUSTED CORRECTLY

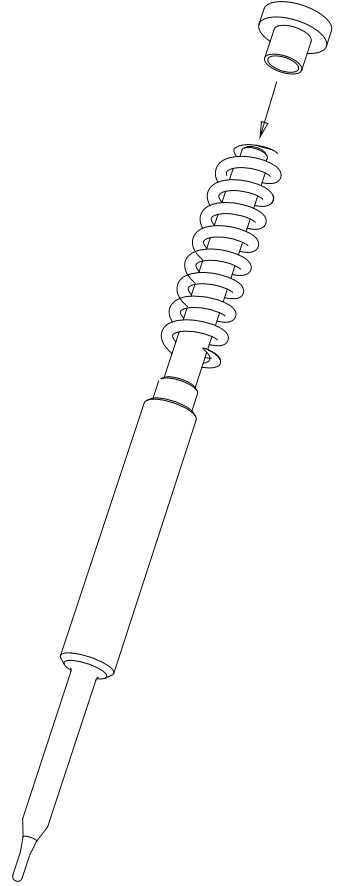
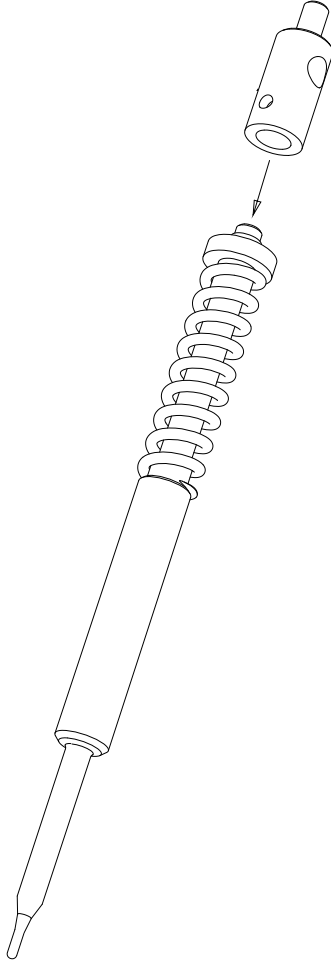
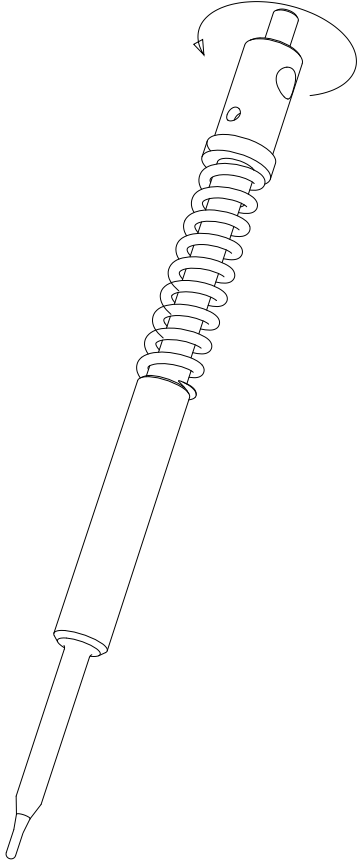
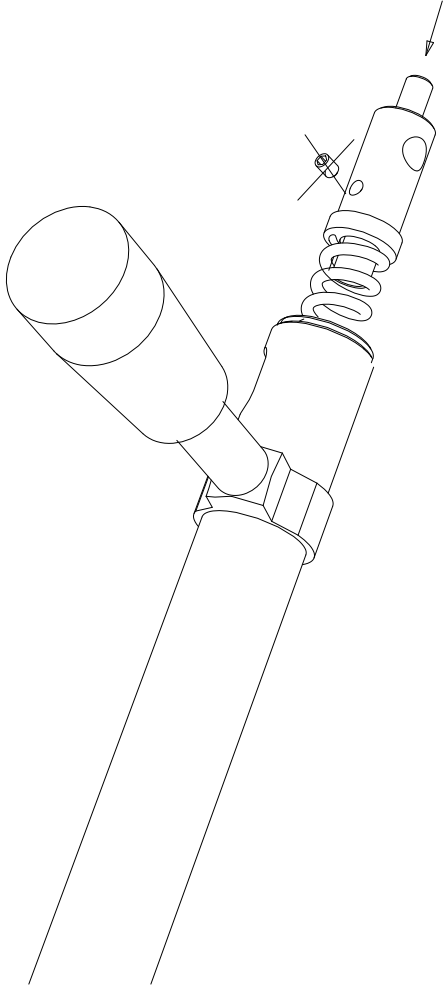

ASSEMBLE THE FIRING PIN



SETTING THE FIRING PIN

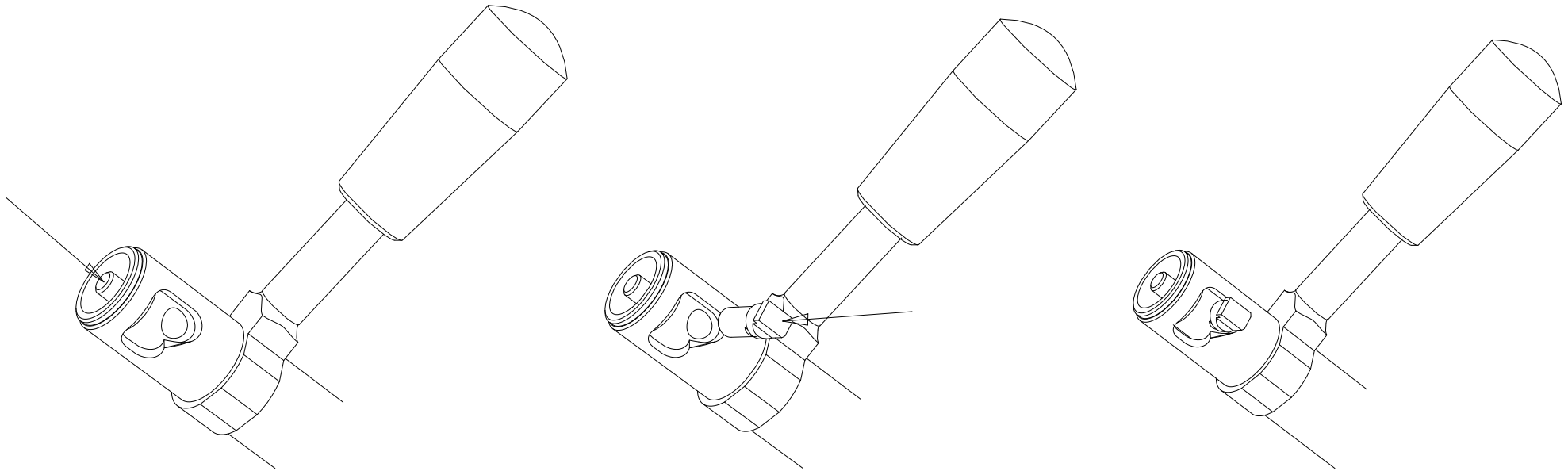

PLACE THE FIRING PIN ASSEMBLY INTO THE BOLT AND ALIGN THE COCKING PIN HOLE TO THE CAM.
INSERT THE COCKING PIN TO CHECK FOR CLEARANCE.



SETTING THE FIRING PIN

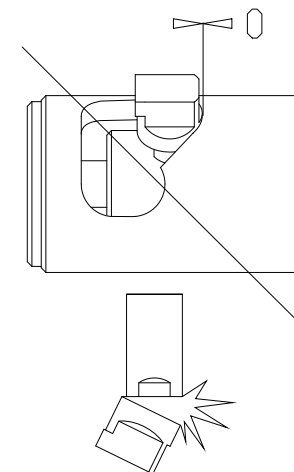
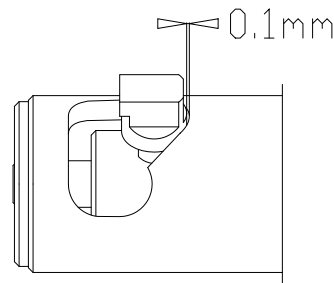
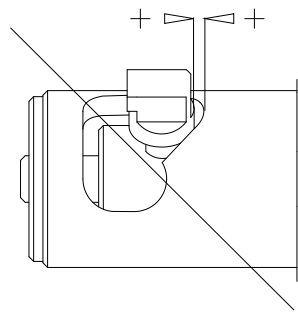
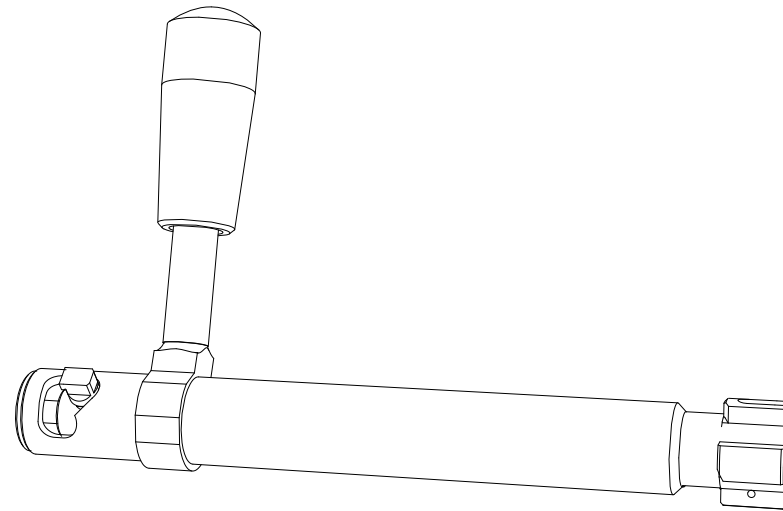

ADJUST THE COCKING PIN CARRIER UNTIL ONLY A VERY SMALL AMMOUNT OF CLEARANCE IS ATTAINED BETWEEN THE COCKING PIN AND THE CAM ON THE BOLT.

IF THIS IS SET WITH TOO MUCH CLEARANCE THERE IS A POSSABILITY THAT YOU WILL GET LIGHT STIKES WHEN THE WEAPON IS FIRED. IF THIS IS SET WITH NO CLEARANCE (THE COCKING PIN HITS THE CAM WHEN FIRED) YOU MAY DAMAGE THE COCKING PIN.



SETTING THE FIRING PIN

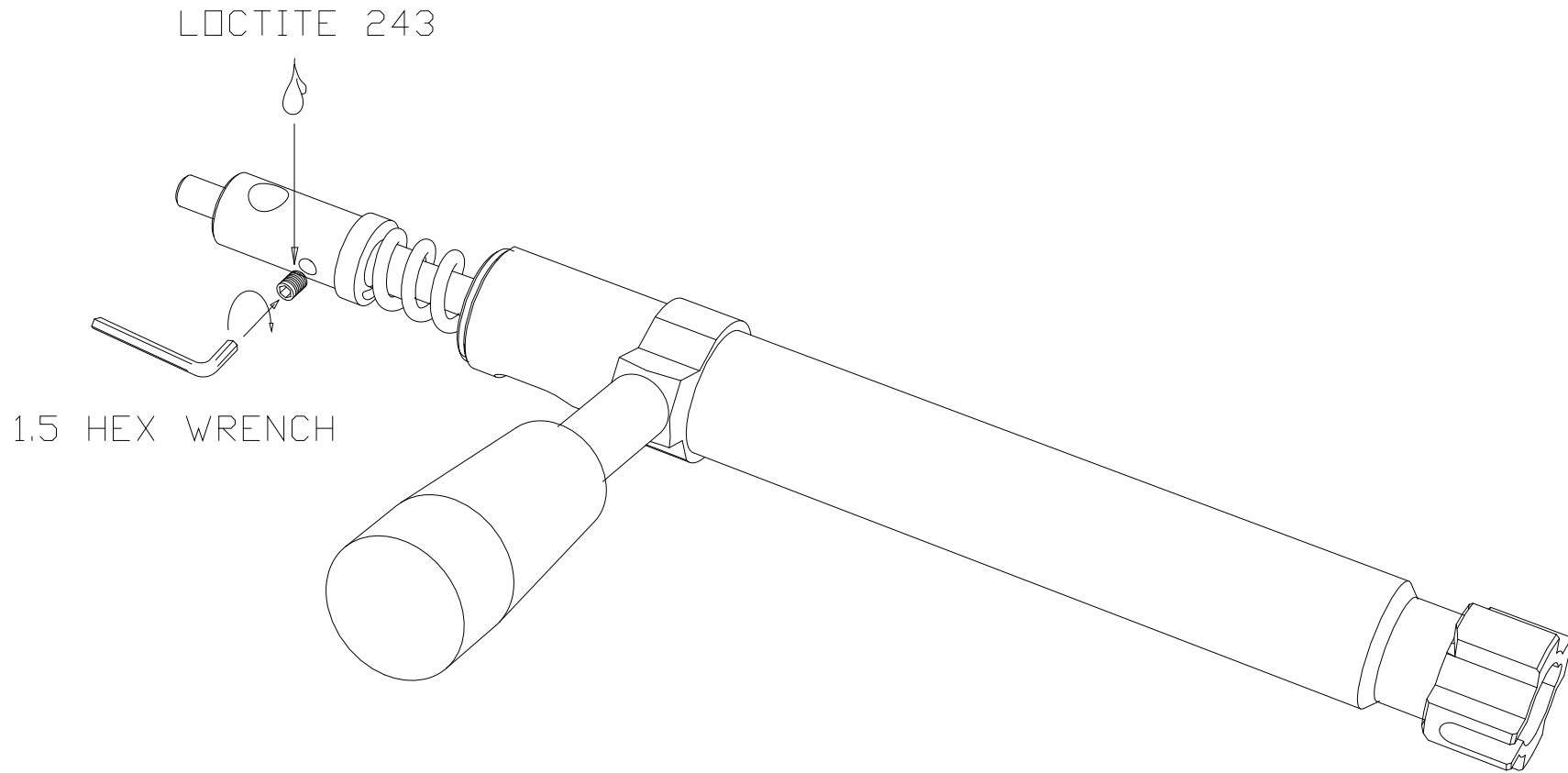

WHEN THE FIRING PIN HAS BEEN SET CORRECTLY, APPLY STUDLOCK TO THE SET SCREW AND SECURE THE COCKING PIN CARRIER INTO PLACE.



SETTING THE FIRING PIN

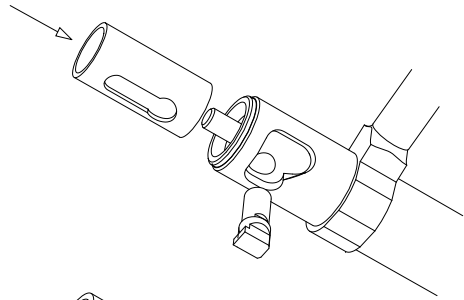

INSERT THE COCKING PIN SLEEVE AND ALIGN THE KEY WAY

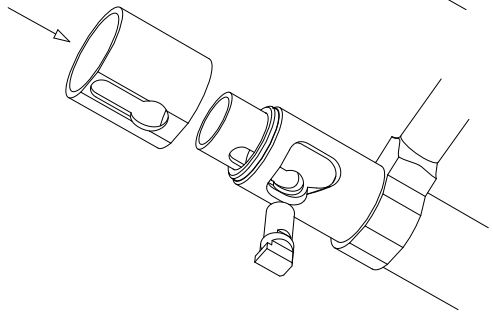

SLIDE OVER THE COCKING PIN SHROUD AND ALIGN THE KEY WAY

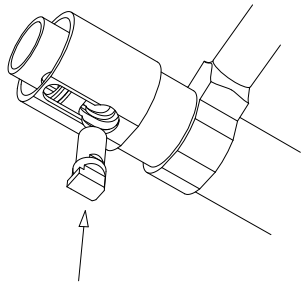

INSERT THE COCKING PIN WITH THE TAIL TO THE REAR

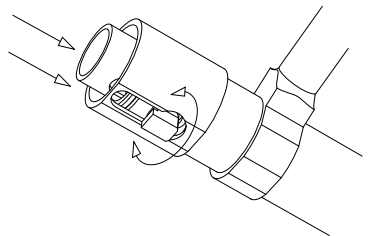

SLIDE IN THE COCKING PIN SLEEVE AND SHROUD TO ARREST THE COCKING PIN

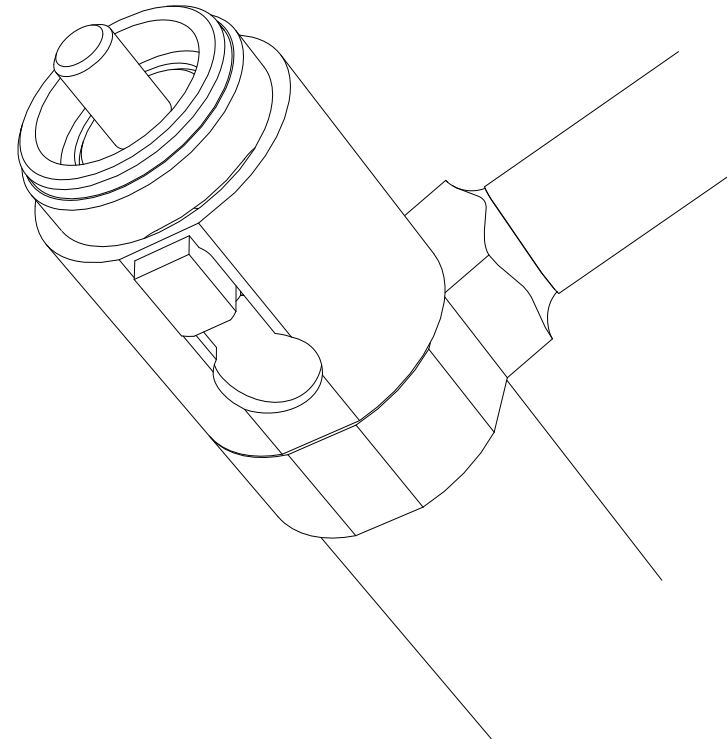

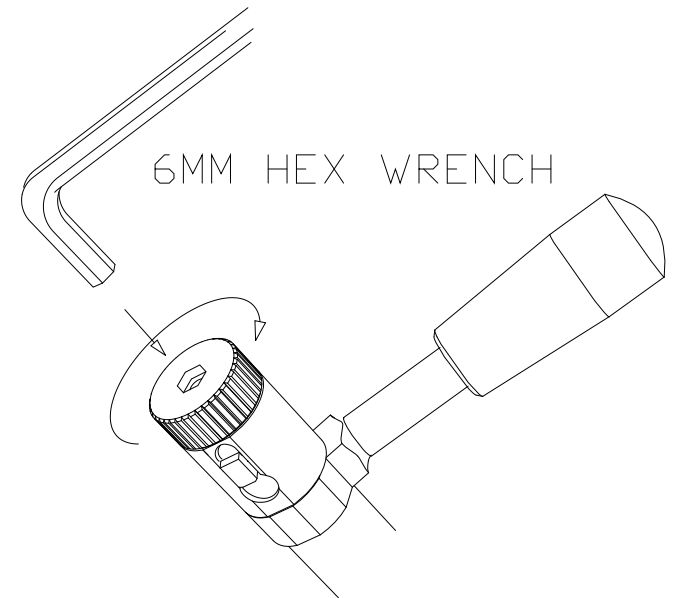
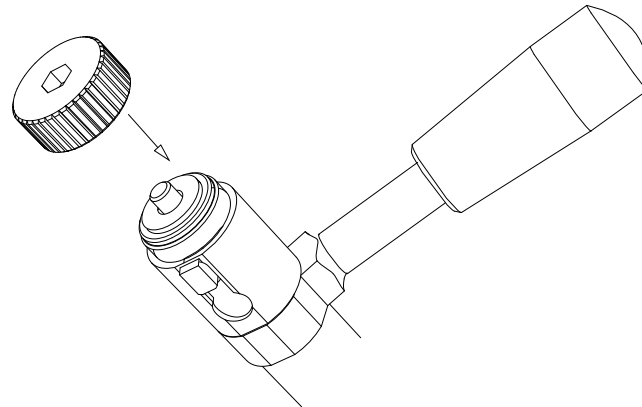
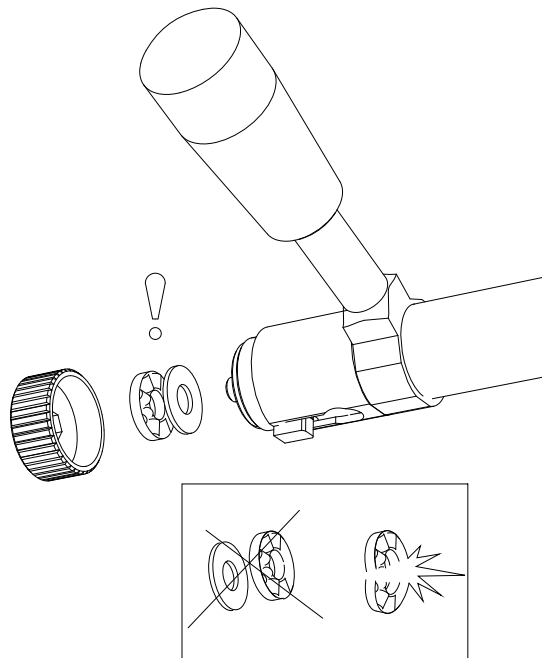

ENSURE THE THRUST BEARINGS ARE INSERTED AS SHOWN OR DAMAGE MAY OCCUR

ROTATE FIRING PIN ASSEMBLY TO THE FIRE POSITION (DE-COCKED) THEN AFFIX THE END CAP

SECURE TIGHTLY WITH 6MM WRENCH RE-COCK THE BOLT BEFORE INSERTING INTO THE RECEIVER